

## OMNI SAN FRANCISCO HOTEL MEETING SPACE

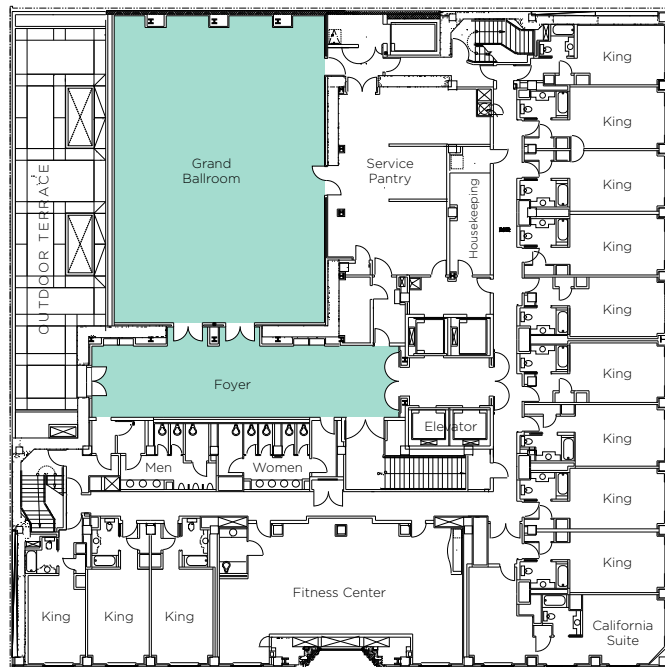

## OMNI SAN FRANCISCO HOTEL MEETING ROOM CAPACITY

	SQUARE FOOTAGE	DIMENSIONS	CEILING HEIGHT	FLOOR COVERING	PORTABLE WALLS	THEATER	CLASSROOM 18"	BANQUET 60"	BANQUET 72"	RECEPTION	HOLLOW SQUARE	EXHIBITS 8' X 10'	CONFERENCE	U-SHAPE
<b>THIRD FLOOR</b>														
GRAND BALLROOM	2,800	44' x 63'8"	15'	CARPET	NO	320	180	190	228	300	70	17	60	70
FOYER	960	64' x 15'	9'	CARPET	—	—	—	—	—	80	—	—	—	—
<b>SECOND FLOOR</b>														
MEZZANINE	1,500	50' x 30'	9'6"	CARPET	—	—	—	110	120	175	—	9	—	—
TELEGRAPH HILL	1,827	29' x 63'	9'	CARPET	YES	120	100	130	120	190	60	11	50	48
TELEGRAPH HILL A	812	29' x 28'	9'	CARPET	YES	50	40	50	48	45	30	—	24	24
TELEGRAPH HILL B	1,015	29' x 35'	9'	CARPET	YES	60	56	60	48	60	36	—	34	30
NOB HILL	679	22'6" x 30'	9'	CARPET	NO	50	32	50	48	50	30	—	20	24
RUSSIAN HILL	679	22'6" x 30'	9'	CARPET	NO	50	32	50	48	50	30	—	20	24
NORTH BEACH	1,196	23' x 52'	9'	CARPET	YES	100	70	90	96	100	54	—	46	48
NORTH BEACH A	624	24' x 26'	9'	CARPET	YES	45	40	60	48	50	24	—	20	18
NORTH BEACH B	572	22' x 26'	9'	CARPET	YES	45	38	50	48	45	30	—	20	24
UNION SQUARE	1,632	24' x 68'	9'	CARPET	NO	150	80	130	132	150	54	10	54	46
WALL STREET WEST	335	14' x 24'	9'6"	CARPET	—	—	—	—	—	—	—	—	12	—

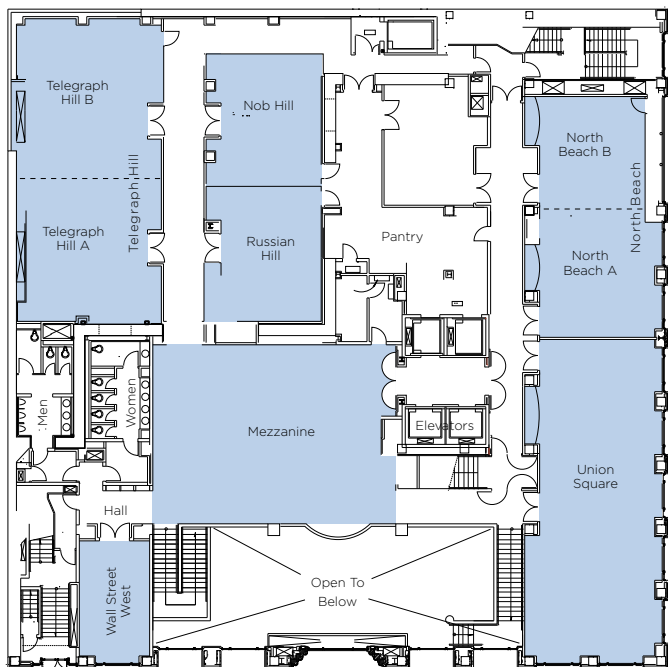

NEVER STAY THE SAME