

# OMNI BARTON CREEK RESORT & SPA MEETING SPACE

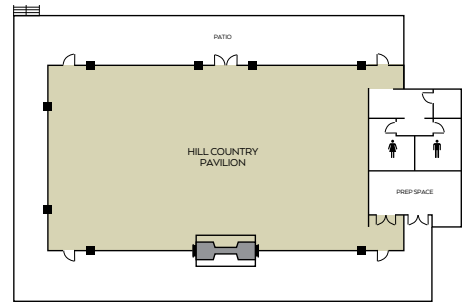
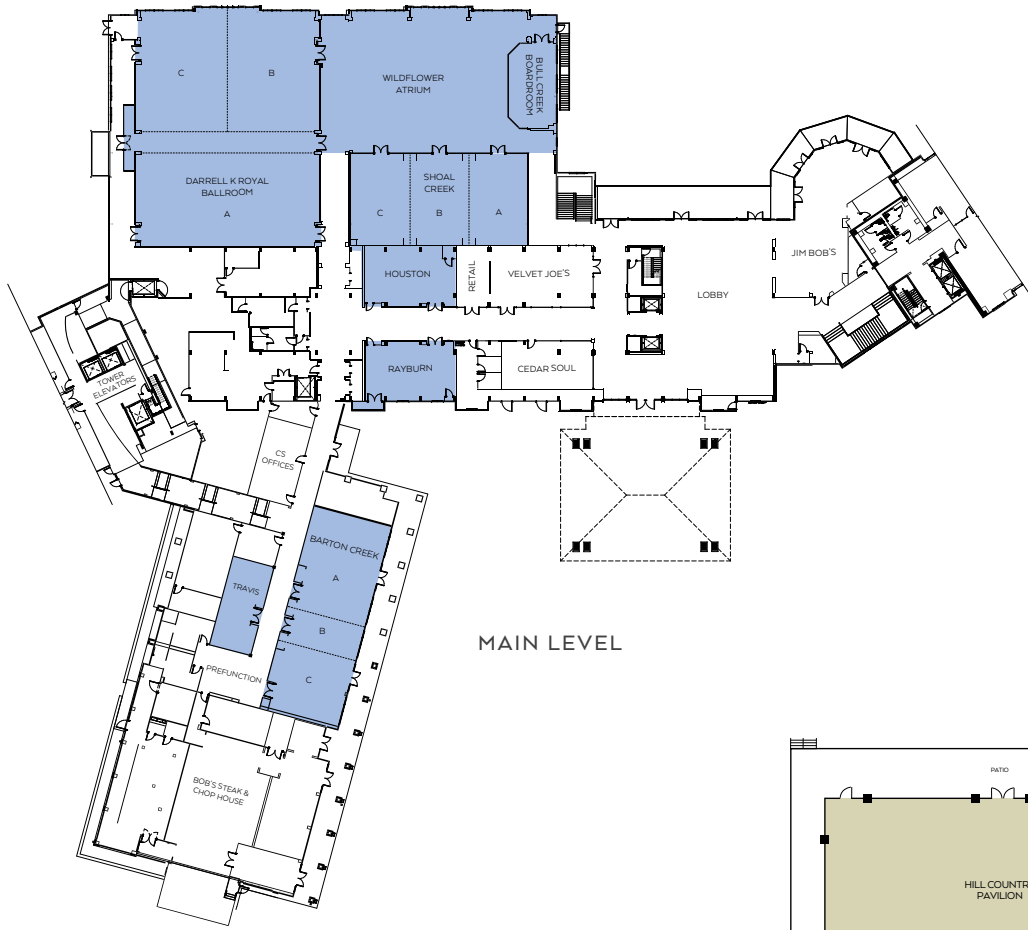

# OMNI BARTON CREEK RESORT & SPA MEETING ROOM CAPACITY

	SQUARE FOOTAGE	DIMENSIONS	WINDOWS	CEILING HEIGHT	BANQUET	THEATER	CLASSROOM 30" (3 PER 6)	RECEPTION	CONFERENCE
<b>MAIN LEVEL</b>									
BARTON CREEK	2,850	89'X32'	YES	16'	160	220	140	280	—
A	1,440	46'X32'	YES	16'	80	100	72	110	36
B	450	14'X32'	YES	16'	—	30	36	30	18
C	960	30'X32'	YES	16'	50	50	60	70	26
A & B	1,890	59'X32'	YES	16'	96	130	90	145	50
B & C	1,410	44'X32'	YES	16'	80	100	90	110	36
HOUSTON	967	378'X25.6'	—	12'	48	50	30	70	26
RAYBURN	1,015	39.5'X25.7'	YES	12'	48	60	30	75	26
TRAVIS	701	178.3'X39'	—	16'	58	78	39	74	17
DARRELL K ROYAL BALLROOM	8,240	103'X80'	YES	12'	560	900	300	700	—
A	3,200/3,920	40'X80'	—	12'	168	340	145	250	—
B	2,160	54'X40'	YES	12'	112	175	80	210	44
C	2,160	54'X40'	YES	12'	112	175	80	210	44
B & C	4,320/5,040	54'X80'	—	12'	240	340	168	300	—
SHOAL CREEK	2,964	76'X39'	—	12'	168	340	106	225	—
A	988	25.3'X39'	—	12'	50	66	40	75	32
B	988	25.3'X39'	—	12'	50	66	40	75	32
C	988	25.3'X39'	—	12'	50	66	40	75	32
A & B OR B & C	1,976	50.5'X39'	—	12'	96	140	72	150	60
BULL CREEK BOARDROOM	740	20'X37'	YES	12'	—	—	—	—	26
WILDFLOWER ATRIUM	2,600	65'X40'	YES	12'	120	270	—	300	—
<b>LOWER LEVEL</b>									
BRAZOS BALLROOM	14,532	92'X158'	—	24'	1,194	1,593	597	1,435	—
A, B, C & D	9,686	92'X105.3'	—	24'	806	1,075	403	969	—
A, B & C	4,846	92'X52.8'	—	24'	403	538	202	485	116
A	1,632	31'X52.8'	—	24'	136	181	68	163	39
B	1,577	30'X52.8'	—	24'	131	175	66	158	38
C	1,637	31.1'X52.8'	—	24'	136	181	68	163	39
D	4,840	92'X52.7'	—	24'	403	537	201	484	116
E	1,632	31'X52.8'	—	24'	136	181	68	163	39
F	1,577	30'X52.8'	—	24'	131	175	66	158	38
G	1,637	31.1'X52.8'	—	24'	136	181	68	163	39
BRAZOS BALLROOM FOYER	5,414	83.6'X63.2'	YES	17'	—	—	—	541	—
TRINITY	950	40'X24.6'	YES	14'	79	105	40	95	23
COLORADO	950	40'X24.6'	YES	14'	79	105	40	95	23
PARLOR A	652	23.9'X25.1'	—	14'	—	—	—	65	—
LLANO	813	39.8'X21.8'	YES	14'	68	90	34	81	20
SAN JACINTO	813	39.8'X21.8'	YES	14'	68	90	34	81	20
PARLOR B	717	23.9'X29'	—	14'	—	—	—	72	—
RIO GRANDE	754	32.9'X25.4'	YES	14'	63	84	31	75	18
GUADALUPE	754	32.9'X25.4'	YES	14'	63	84	31	75	18
PARLOR C	706	29.3'X26'	—	14'	—	—	—	71	—
<b>OUTDOOR SPACE</b>									
HILL COUNTRY PAVILION	5,556	93.1'X59.3'	—	20'	462	617	231	556	133
HILL COUNTRY COURTYARD	2,892	—	—	—	—	—	—	—	—
HILL COUNTRY LAWN	10,400	—	—	—	950	—	—	1,200	—
LADY BIRD LAWN	4,593	—	—	—	—	—	—	670	—
ROCK HOUSE	7,500	—	—	—	300	—	—	—	—

Meeting room capacities are determined by the use of the "Arranger & Comfort Calculator," a standardized meeting room capacity measurement system used by Meeting Professionals International. 66" banquet capacities are based on 10 persons per table.