

**MAIN LEVEL & QUAIL LODGE**

1

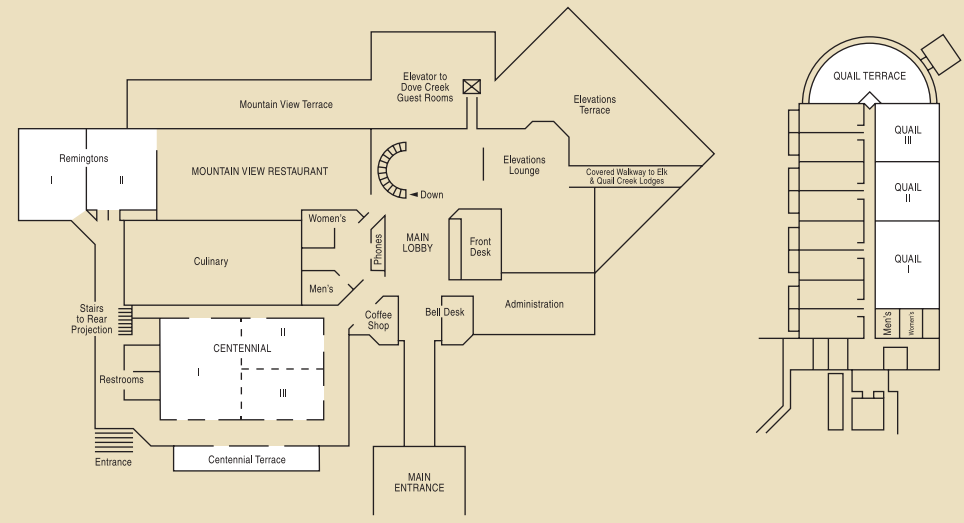

| Specific Rooms      | Dimension | Area | Classroom | Theatre | U-Shape | Hollow Square | Reception | Banquet |
|---------------------|-----------|------|-----------|---------|---------|---------------|-----------|---------|
| Centennial Room     | 92' x 53' | 4876 | 256       | 360     | 108     | 136           | 500       | 350     |
| Centennial I        | 46' x 53' | 2438 | 125       | 170     | 54      | 72            | 200       | 180     |
| Centennial II       | 46' x 26' | 1196 | 48        | 108     | 32      | 30            | 125       | 80      |
| Centennial III      | 46' x 26' | 1196 | 48        | 108     | 32      | 30            | 125       | 80      |
| Centennial II & III | 46' x 53' | 2438 | 125       | 170     | 54      | 72            | 200       | 180     |
| Centennial Terrace  | 19' x 70' | 1330 | N/A       | 150     | N/A     | N/A           | 142       | 95      |
| Remingtons          | 82' x 43' | 3526 | 200       | 325     | N/A     | N/A           | 300       | 240     |
| Remington I         | 40' x 43' | 1720 | 68        | 100     | 39      | 52            | 150       | 100     |
| Remington II        | 42' x 43' | 1806 | 70        | 100     | 35      | 36            | 150       | 110     |
| Quail I             | 41' x 26' | 1066 | 48        | 80      | 35      | 40            | 75        | 60      |
| Quail II            | 26' x 26' | 676  | 24        | 55      | 23      | 28            | 50        | 30      |
| Quail III           | 26' x 26' | 676  | 24        | 55      | 23      | 28            | 50        | 30      |
| Quail Terrace       | 28' x 50' | 1400 | N/A       | 120     | N/A     | N/A           | 125       | 80      |

**CONFERENCE LEVEL**

2

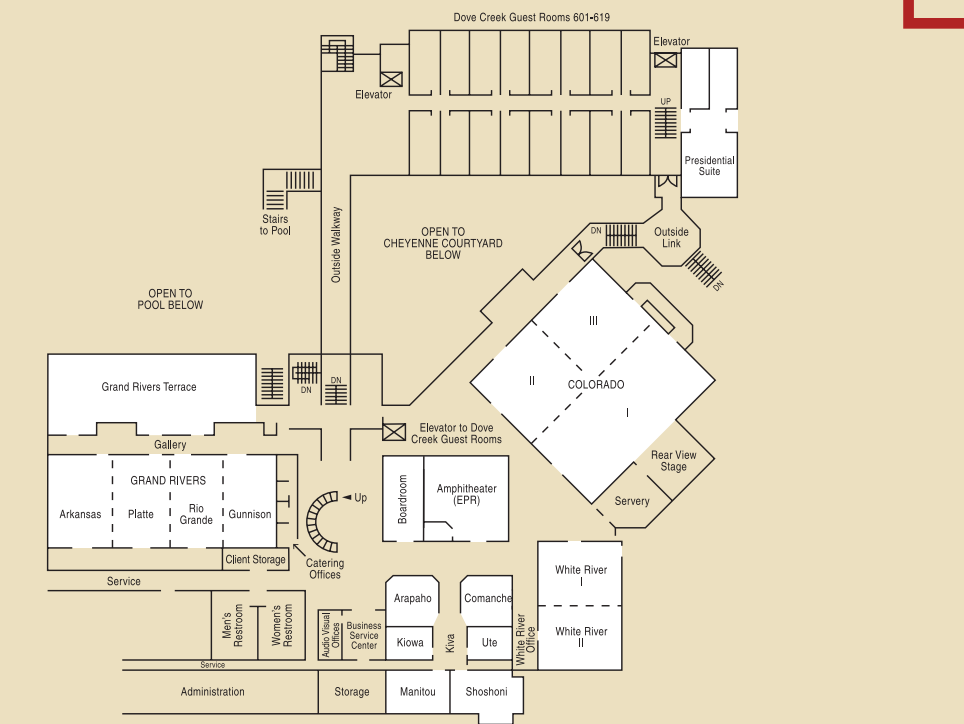

| Specific Rooms                | Dimension  | Area | Classroom | Theatre | U-Shape | Hollow Square | Reception | Banquet |
|-------------------------------|------------|------|-----------|---------|---------|---------------|-----------|---------|
| Colorado                      | 80' x 80'  | 6400 | 400       | 600     | 108     | 144           | 600       | 500     |
| Colorado I                    | 40' x 80'  | 3200 | 180       | 288     | 90      | 108           | 300       | 260     |
| Colorado II                   | 40' x 40'  | 1600 | 90        | 96      | 39      | 44            | 150       | 90      |
| Colorado III                  | 40' x 40'  | 1600 | 90        | 96      | 39      | 44            | 150       | 90      |
| Colorado II & III             | 40' x 80'  | 3200 | 180       | 180     | 90      | 108           | 300       | 260     |
| Grand Rivers Room             | 107' x 43' | 4601 | 288       | 368     | 102     | 120           | 400       | 280     |
| Arkansas                      | 29' x 43'  | 1247 | 61        | 78      | 35      | 40            | 125       | 80      |
| Platte                        | 29' x 43'  | 1247 | 61        | 78      | 35      | 40            | 125       | 80      |
| Rio Grande                    | 24' x 43'  | 1032 | 45        | 65      | 32      | 36            | 90        | 60      |
| Gunnison                      | 25' x 43'  | 1075 | 45        | 65      | 32      | 36            | 90        | 60      |
| Grand Rivers Terrace          | 81' x 36'  | 2916 | N/A       | 180     | N/A     | N/A           | 175       | 140     |
| Arkansas & Platte             | 58' x 43'  | 2494 | 126       | 208     | 57      | 57            | 225       | 160     |
| Rio Grande & Gunnison         | 49' x 43'  | 2107 | 108       | 144     | 45      | 52            | 200       | 170     |
| Arkansas, Platte & Rio Grande | 82' x 43'  | 3526 | 216       | 336     | 84      | 96            | 325       | 240     |
| Arapaho or Comanche           | 19' x 24'  | 456  | 20        | 28      | 12      | 16            | 40        | 20      |
| Kiowa or Ute                  | 17' x 19'  | 323  | 18        | 27      | 10      | 14            | 30        | 10      |
| Manitou or Shoshoni           | 19' x 29'  | 551  | 36        | 45      | 22      | 26            | 50        | 40      |
| Boardroom                     | 37' x 19'  | 703  | N/A       | N/A     | N/A     | N/A           | N/A       | 18      |
| Amphitheater (EPR)            | 40' x 40'  | 1600 | 100       | N/A     | N/A     | N/A           | N/A       | N/A     |
| White River                   | 60' x 40'  | 2400 | 162       | 216     | 57      | 70            | 200       | 180     |
| White River I                 | 30' x 40'  | 1200 | 55        | 78      | 35      | 40            | 125       | 90      |
| White River II                | 30' x 40'  | 1200 | 55        | 78      | 35      | 40            | 125       | 90      |

**COURTYARD LEVEL**

3

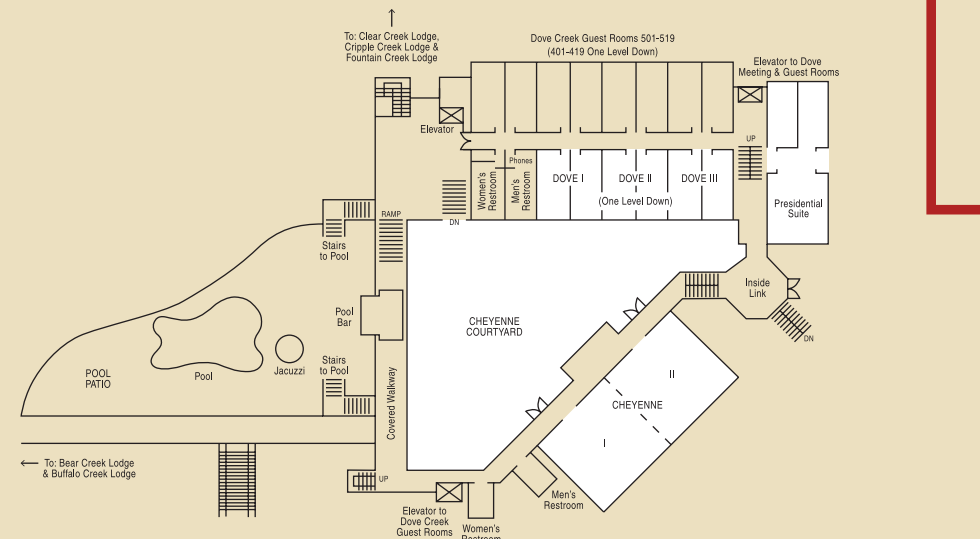

| Specific Rooms     | Dimension | Area | Classroom | Theatre | U-Shape | Hollow Square | Reception | Banquet |
|--------------------|-----------|------|-----------|---------|---------|---------------|-----------|---------|
| Dove I             | 27' x 27' | 729  | 33        | 50      | 21      | 27            | 65        | 40      |
| Dove II            | 27' x 27' | 729  | 33        | 50      | 21      | 27            | 65        | 40      |
| Dove III           | 27' x 27' | 729  | 33        | 50      | 21      | 27            | 65        | 40      |
| Cheyenne Room      | 40' x 78' | 3120 | 160       | 324     | 67      | 80            | 285       | 180     |
| Cheyenne I         | 40' x 38' | 1520 | 72        | 96      | 39      | 44            | 150       | 90      |
| Cheyenne II        | 40' x 40' | 1600 | 72        | 96      | 39      | 44            | 135       | 90      |
| Cheyenne Courtyard | 70' x 80' | 5600 | N/A       | 500     | N/A     | N/A           | 550       | 420     |