

Meetings & Event Guide.

OMNI SHOREHAM HOTEL

EXPERIENCES MATTER HERE



OMNI
SHOREHAM

Table *of* Contents

MEETINGS & EVENTS OVERVIEW	01
ABOUT.....	02
EVENT VENUES	04
HIGHLIGHTS.....	07



Unforgettable Moments in UNMATCHED WASHINGTON, D.C.

Tucked into a quiet residential neighborhood near the iconic landmarks of Washington, D.C., the historic Omni Shoreham Hotel is the city's premier meeting destination. Since the 1930s, Omni Shoreham has welcomed a who's who of celebrities, from senators and presidents to entertainers like Louis Armstrong, Aretha Franklin and The Beatles. Just like these luminaries, your event guests will find all the comforts they desire, with 834 inviting guest rooms, a resort-style outdoor pool, locally infused dining options, and onsite spa.

With 100,000 square feet of meeting and event space across 11 acres, Omni Shoreham Hotel can host meetings, conferences, weddings, and events of all types. The 15,700 square foot Regency Ballroom is production-ready with 22 ft ceilings and multiple rigging points, while the 6,200 square foot Ambassador Ballroom maintains its historic character with stately pillars and arched windows. Multiple outdoor spaces create an event experience that matters.



about
Omni Shoreham
Hotel.

SERENITY IN THE CITY

Located in one of Washington D.C.'s premier neighborhoods, Omni Shoreham Hotel is a calm escape in the heart of the nation's bustling capital. Lounge poolside in the warmer months, or enjoy luxurious spa treatments and fine dining year round. After exploring some of D.C.'s most recognized landmarks nearby, you'll find this tranquil retreat a welcome respite from the city beyond.

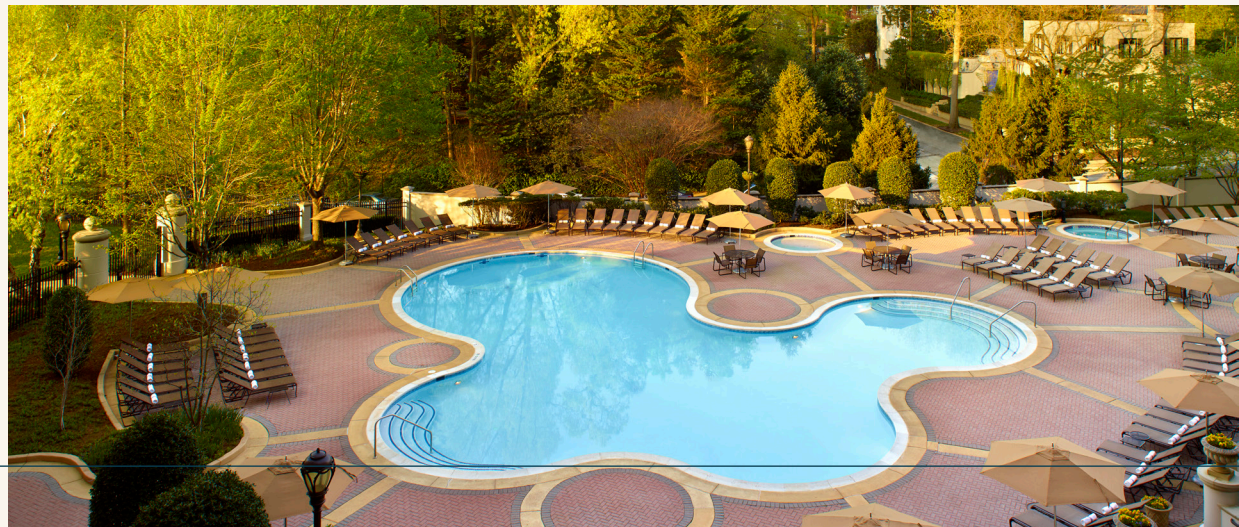

An event to remember

- 834 guest rooms and suites with historic influences and modern amenities
- 100,000 square feet of meeting, event and pre-function space, including the 15,700 square foot Regency Ballroom and 25,000 square feet of lawns and terraces
- On-site audiovisual equipment services offering the latest technology and Wi-Fi internet access
- A heated, outdoor resort pool surrounded by landscaped gardens and lounge chairs
- Three unique dining experiences including Robert's Restaurant specializing in local fare from area farms; small bites and cocktails at Marquee Bar & Lounge; and coffee, fresh pastries and grab-and-go sandwiches from Morsel's
- Shoreham Spa & Health Club offering hydrating facials, soothing massages and additional treatments
- 24-hour fitness center fully equipped with free weights, pelotons, treadmills, ellipticals and Cybex weight machines

TAKE A VIRTUAL TOUR OF THE OMNI SHOREHAM HOTEL

Flexible, Next Generation Event & Meeting Space.

LOBBY LEVEL

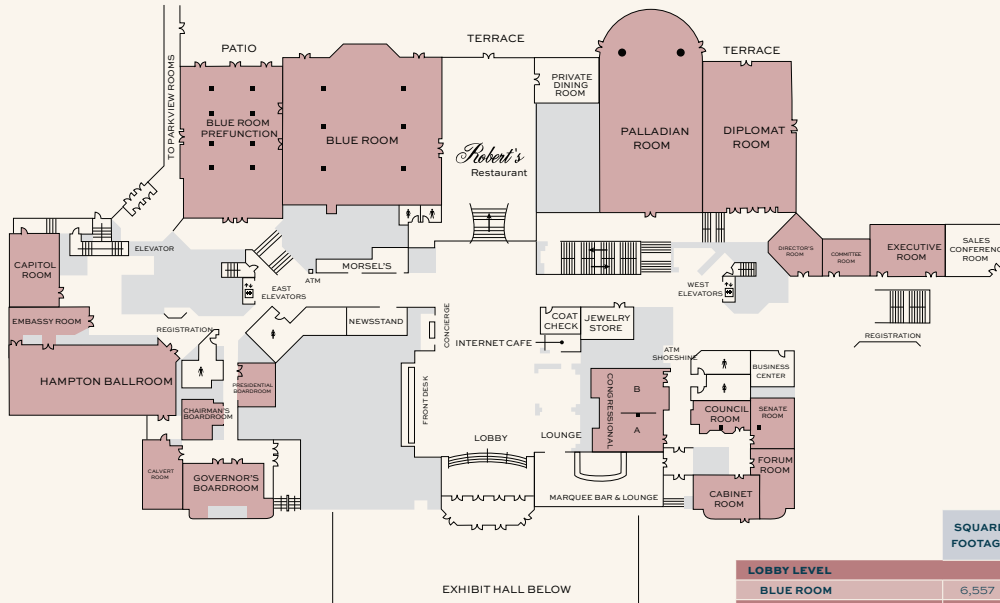

	SQUARE FOOTAGE	DIMENSIONS L x W	CEILING HEIGHT	THEATER	CLASS-ROOM 2 PER 6'	CLASS-ROOM 3 PER 6'	BANQUET	RECEPTION	1/2 ROUNDS CRESCENT	HOLLOW SQUARE	U-SHAPE	8' X 10' BOOTHS	CONF.
LOBBY LEVEL													
BLUE ROOM	6,557	79' X 83'	13'6"	700	226	400	560	1,500	310	80	70	40	—
BLUE ROOM PREFUNCTION	4,320	80' X 54'	13'6"	285	100	150	280	700	168	60	50	—	—
PALLADIAN BALLROOM	5,616	52' X 108'	13'6"	500	216	324	450	1,200	315	80	70	29	—
DIPLOMAT BALLROOM	3,496	46' X 76'	15'2"	400	168	252	280	800	168	80	70	26	—
HAMPTON BALLROOM	3,256	88' X 37'	9'10"	300	140	210	290	500	182	80	70	16	—
CAPITOL ROOM	912	38' X 24'	8'10"	85	30	45	70	80	35	30	28	—	34
CALVERT ROOM	684	38' X 18'	9'	75	24	36	70	100	42	30	28	—	34
EMBASSY ROOM	588	42' X 14'	8'10"	65	20	30	50	75	28	—	—	—	34
CHAIRMAN'S BOARDROOM	399	21' X 19'	8'3"	25	10	15	30	50	21	—	—	—	16
GOVERNOR'S BOARDROOM	840	40' X 21'	8'10"	80	32	48	70	100	56	36	33	—	34
PRESIDENTIAL BOARDROOM	551	29' X 19'	8'3"	—	—	—	—	—	—	—	—	—	12
EXECUTIVE ROOM	1,200	20' X 60'	9'6"	130	44	66	100	150	84	50	47	—	48
CONGRESSIONAL A & B	1,680	48' X 35'	10'4"	180	80	120	130	200	84	46	40	—	40
CONGRESSIONAL A	840	24' X 35'	10'4"	90	28	42	60	100	42	34	26	—	40
CONGRESSIONAL B	816	24' X 34'	10'4"	90	28	42	60	100	42	34	26	—	30
SENATE ROOM	594	27' X 22'	8'3"	50	16	24	40	70	28	24	21	—	20
CABINET ROOM	561	33' X 17'	8'3"	65	24	36	50	70	35	—	—	—	28
COUNCIL ROOM	486	27' X 18'	8'3"	42	14	21	30	50	21	—	—	—	22
FORUM ROOM	476	34' X 14'	8'3"	60	24	36	40	60	28	—	—	—	34
DIRECTOR'S ROOM	378	21' X 18'	9'4"	32	12	18	30	50	21	—	—	—	16
COMMITTEE ROOM	289	17' X 17'	9'4"	25	8	12	20	30	—	—	—	—	12

Meeting Room Capacities Were Determined Using 72" Rounds Of 10 (Rounds Capacity), Three Chairs Per 6' X 30" Table (U-Shape Capacity) And Three Chairs Per 6' X 18" Table (Classroom Capacity) Allowing For Minimal Audio-visual Equipment.

Flexible, Next Generation Event & Meeting Space.

LOWER LEVEL - EXHIBIT

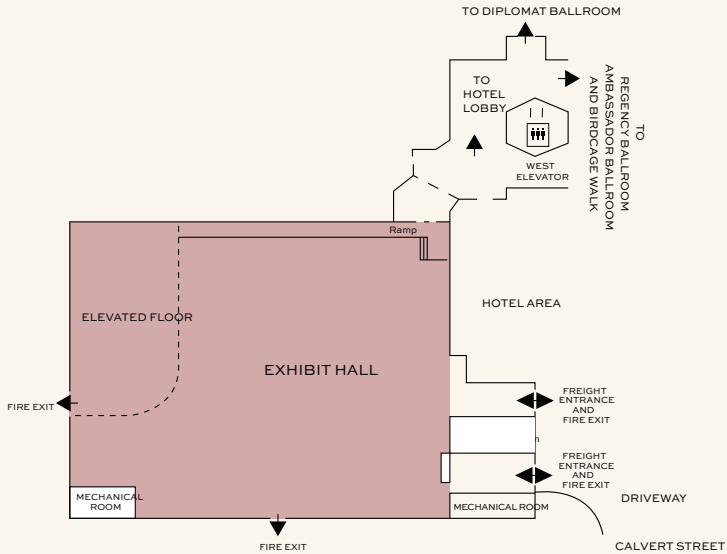

	SQUARE FOOTAGE	DIMENSIONS L x W	CEILING HEIGHT	THEATER	CLASS-ROOM 2 PER 6'	CLASS-ROOM 3 PER 6'	BANQUET	RECEPTION	1/2 ROUNDS CRESCENT	HOLLOW SQUARE	U-SHAPE	8' X 10' BOOTHS	CONF.
LOWER LEVEL — EXHIBIT													
EXHIBIT HALL	40,887	231' X 177'	8'6"				10' X 10' BOOTHS = 130				—	165	—

Meeting Room Capacities Were Determined Using 72" Rounds Of 10 (Rounds Capacity), Three Chairs Per 6'X30" Table (U-Shape Capacity) And Three Chairs Per 6'X18" Table (Classroom Capacity) Allowing For Minimal Audio-visual Equipment.

TAKE A VIRTUAL TOUR OF THE OMNI SHOREHAM HOTEL

Flexible, Next Generation Event & Meeting Space.

LOWER LEVEL

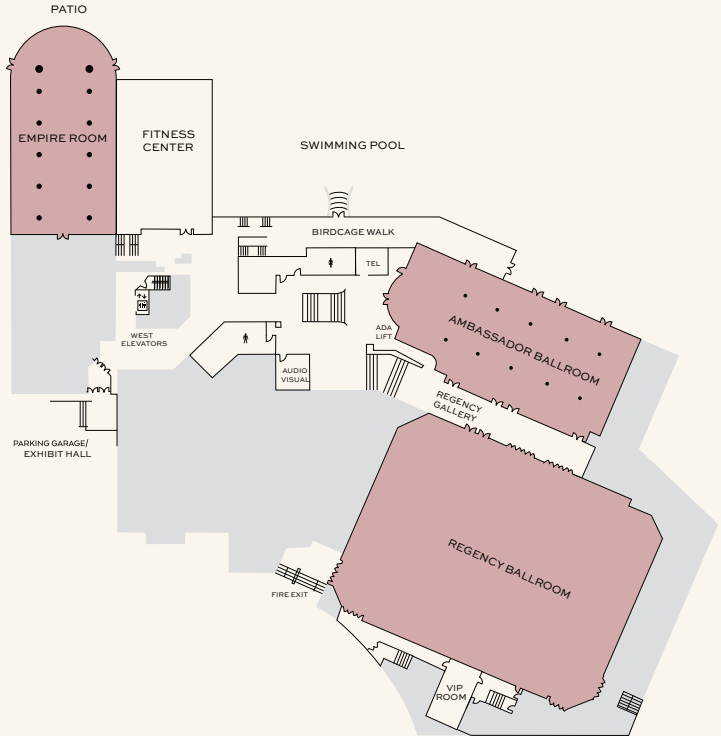

	SQUARE FOOTAGE	DIMENSIONS L x W	CEILING HEIGHT	THEATER	CLASS-ROOM 2 PER 6'	CLASS-ROOM 3 PER 6'	BANQUET	RECEPTION	1/2 ROUNDS CRESCENT	HOLLOW SQUARE	U-SHAPE	8' X 10' BOOTHS	CONF.
LOWER LEVEL													
REGENCY BALLROOM	15,718	1075' X 1485"	22'	2,200	800	1,200	1,400	3,500	1,092	—	—	90	—
AMBASSADOR BALLROOM	6,216	56' X 111'	14'6"	500	190	285	500	1,200	357	80	70	25	—
EMPIRE BALLROOM	5,550	50' X 111'	11'7"	500	176	264	490	1,000	306	80	70	31	—

Meeting Room Capacities Were Determined Using 72" Rounds Of 10 (Rounds Capacity), Three Chairs Per 6'X30" Table (U-Shape Capacity) And Three Chairs Per 6'X18" Table (Classroom Capacity) Allowing For Minimal Audio-visual Equipment.

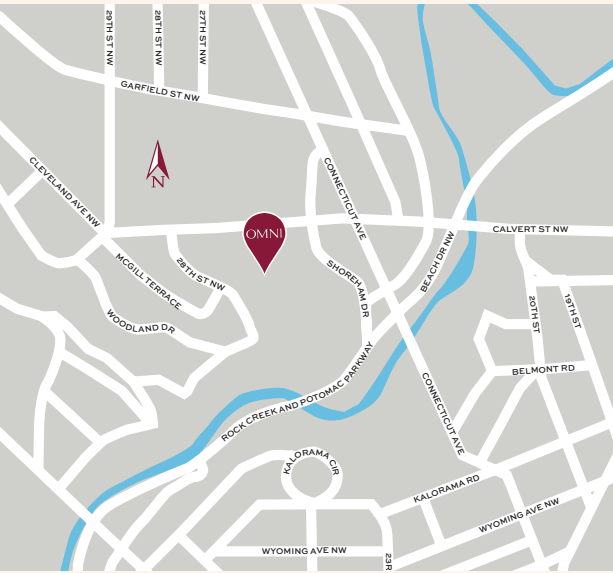

Washington, D.C.

highlights.

OMNI SHOREHAM HOTEL
2500 CALVERT STREET NW, WASHINGTON,
DISTRICT OF COLUMBIA 20008
TAKE A VIRTUAL TOUR OF
THE OMNI SHOREHAM HOTEL

With more historic buildings and iconic cultural landmarks than any other American city, Washington D.C. is a must-visit. Tour the instantly-recognizable monuments on the National Mall and take a White House tour. Visit the Smithsonian Institute campus, with over a dozen distinct museums and galleries to choose from. Make your travels easy—Omni Shoreham offers bike rentals and Metro access, so you can see the best of D.C. without the hassle of parking.

AIRPORTS

Ronald Reagan Washington National Airport (DCA) | 15 min
Dulles International Airport (IAD) | 33 min

ATTRACTIONS

National Zoo | 4 blocks
National Mall (Lincoln Memorial, Washington Monument, Vietnam Veterans Memorial) | 10 min
The White House | 11 min
Arlington National Cemetery | 12 min
The U.S. Capitol | 20 min

ARTS & CULTURE

National Geographic Museum | 8 min
US Holocaust Memorial Museum | 13 min
National Theatre | 14 min
Ford's Theatre | 16 min
Smithsonian Institute | 15 min

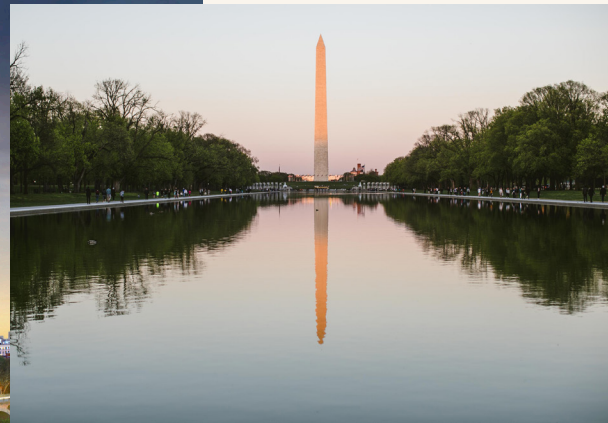



The SHOREHAM

Connecticut Avenue at Calvert Street
Washington 8, D.C.

OMNI SHOREHAM

OMNIHOTELS.COM/DC
WASSHO.LEADS@OMNIHOTELS.COM